

First Floor Plan

Section A-A

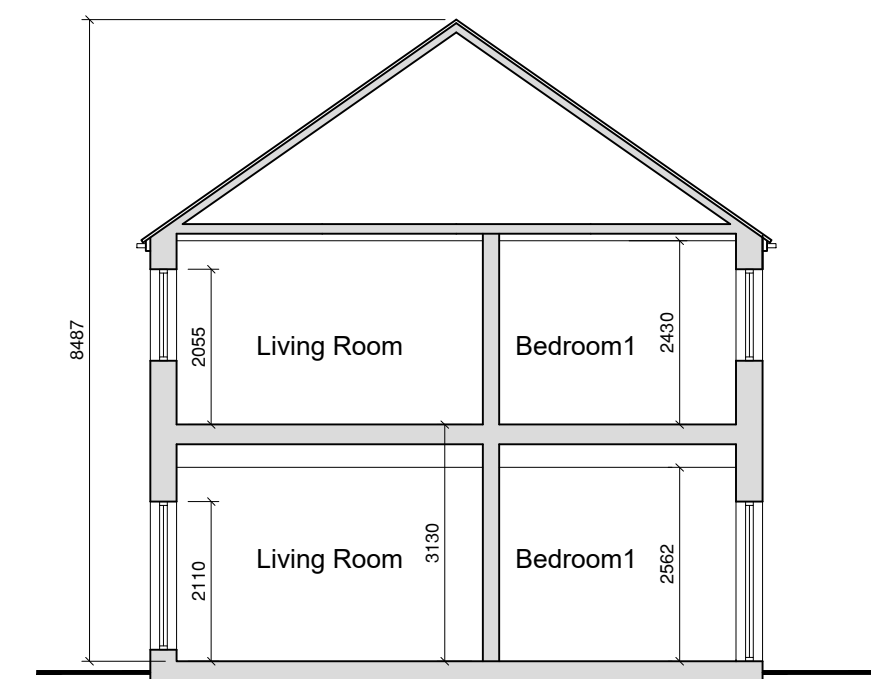
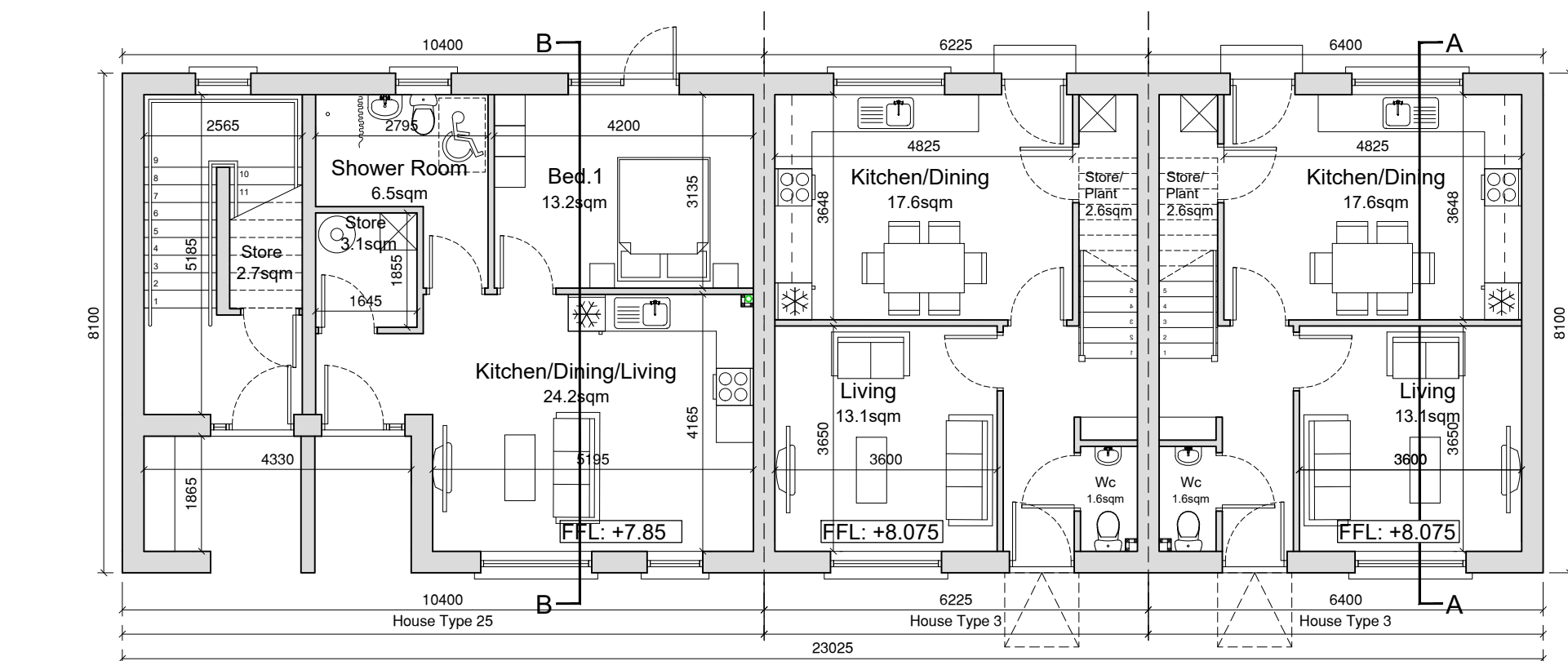

Ground Floor Plan

Section B-B

House Type 3

Quality Housing for Sustainable Communities Standards

2 Bedroom / 4 Person House (2 Storey) Areas:

	Target Gross Floor Areas (m ²)	Min-Main Living Room (m ²)	Aggregate Living Area (m ²)	Aggregate Bedroom Area (m ²)	Storage (m ²)
Required	80 sqm	13 sqm	30sqm	25 sqm	4 sqm
Provided	87sqm	13.1 sqm	30.7sqm	24.8 sqm	6.0 sqm

3 Bedroom / 5 Person (2 Storey) Widths:

	Single Bedroom (m)	Double Bedroom (m)	Living Rm [1 Bed] (m)	Living Rm [2 Bed] (m)	Living Rm [3 Bed] (m)
Required	2.1m	2.8m	3.3m	3.6m	3.8m
Provided	-	3.1 m	-	3.6 m	-

House Type 25

Quality Housing for Sustainable Communities Standards

1 Bedroom / 2 Person (apt) Areas:

	Target Gross Floor Areas (m ²)	Aggregate Living Area (m ²)	Aggregate Bedroom Area (m ²)	Storage (m ²)
Required	45 sqm	23sqm	11.4 sqm	3 sqm
Provided	GF 48.3sqm FF 48.3sqm*	GF 24.2sqm FF 24.2sqm	GF 13.2sqm FF 13.2sqm	GF 3.1sqm FF 5.8sqm

2 Bedroom / 3 Person (apt) Widths:

	Single Bedroom (m)	Double Bedroom (m)	Living Rm [1 Bed] (m)	Living Rm [2 Bed] (m)	Living Rm [3 Bed] (m)
Required	2.1m	2.8m	3.3m	3.6m	3.8m
Provided	-	GF 3.15sqm FF 3.15sqm	GF 4.2sqm FF 4.2sqm	-	-

*Excluding Stairs

External Finishes Schedule

Roof:	Blue/Black Fibre cement Slate Dry Verge Finish.
Walls:	White External Render - Smooth/dashed Brick detail at Entrances
Windows & Doors:	Grey AluClad/uPVC
Rain Water Goods:	Black uPVC

